

# HITACHI ELECTROMAGNETIC SWITCH

Type	Rated insulation voltage (Ui)	Max. rated capacity of motor			Rated thermal current (AC1 = 1th)	Applicable standard	Aux. Contact	Weight
		240V	5.5kW	22A				
HS20-TG	AC 690 V	240V	5.5kW	22A	32 A	IEC 60947-4-1	1a1b or 2a2b	0.81 kg
HS20-TKG		440V	11kW	22A				

※WITH AUX. CONTACT SIDE ON UNIT = 88mm.

※WITH AUX. CONTACT HEAD ON UNIT = 145mm.

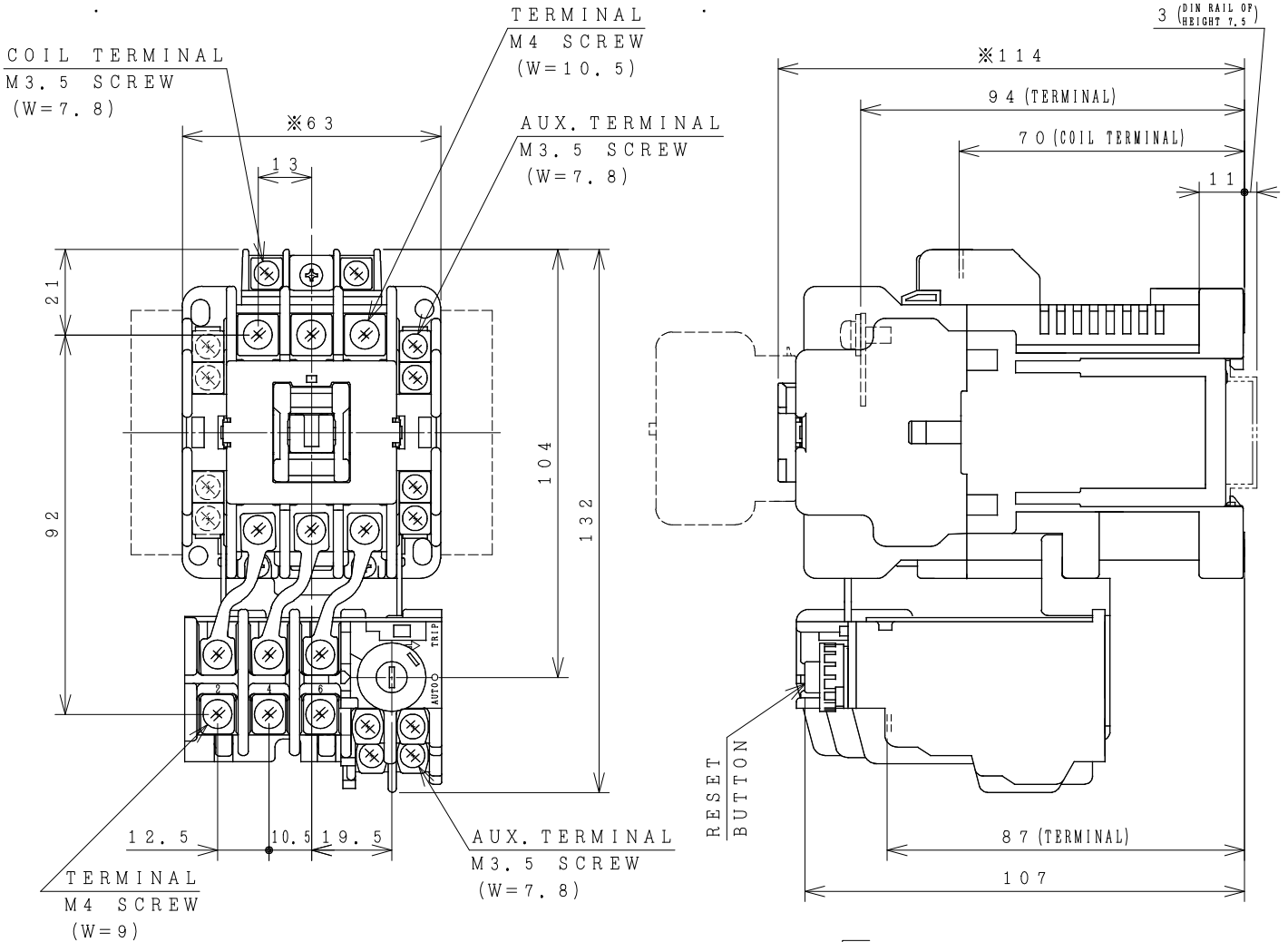

OUTLINE DIMENSIONS.

※IN CASE OF 2E THERMAL OVERLOAD RELAY.

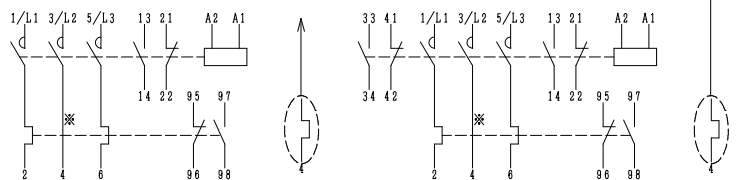

AUX. CONTACTS: 1 a 1 b

2 a 2 b

CONTACTS ARRANGEMENT.

54 x 56 MOUNTING HOLES.  
 54 x 60 ALSO POSSIBLE.  
 (W) : WIDTH OF TERMINAL.

※REMARK

- DIMENSION UNIT = Millimeter (mm).
- (a) = AUX. CONTACT NORMALLY OPENED.
- (b) = AUX. CONTACT NORMALLY CLOSED.

(Reference 43068988R00).

DWN. O. SITTICHAJ 05/07/16	PROJECTION	TITLE
CHKD. <i>C. Kiatissak</i>	SCALE	DIMENSION OF HS20-TG, TKG
APPD. <i>T. Kiatissak</i>	NTS.	
HITT WORKS DWG. No.		REV.
<b>HITACHI</b> Hitachi Industrial Technology (Thailand), Ltd.		00
		SH.
		01
		01

4HTN000801