

ENGINEERING SHEET	TITLE BTK63 MINIATURE CIRCUIT BREAKER SPECIFICATION	CODE	WORK CODE
--------------------------	---	------	-----------

Technical data

Type	BTK63	
Rate operation voltage (Ue)	415VAC	
Protection	Overload and short circuit	
Rate current	1, 2, 3, 4, 6, 10, 16, 20, 25, 32, 40, 50, 63A	
Characteristics	B,C,D curve	
Number of poles	1P, 1P+N, 2P, 3P, 3P+N, 4P	
Breaking capacity	1P	2, 3, 4P
	10kA at 240/415VAC	10kA at 415VAC
Standards	IEC60898	
Approval	KEMA CB scheme	
Type of trip	Thermal magnetic release	
Electrical endurance	8,000 operations	
Installation	35mm DIN rail	
Width	17.8mm per pole	
Type of terminal	Lug type (Cable up to 25mm ²)	
Alarm switch (option)	Not applicable	

Tripping characteristics

- Type B:
 - Instant tripping characteristics: 3 - 5In
 - Application: Computer and electronic equipments
- Type C:
 - Instant tripping characteristics: 5 - 10In
 - Application: General load such as bulbs, motors
- Type D:
 - Instant tripping characteristics: 10 - 20In
 - Application: High current surge device such as transformer, motor with heavy load

Dimension (mm.)

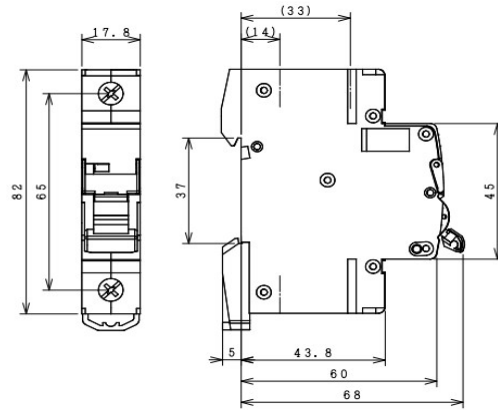

Characteristic curve and compensation curve

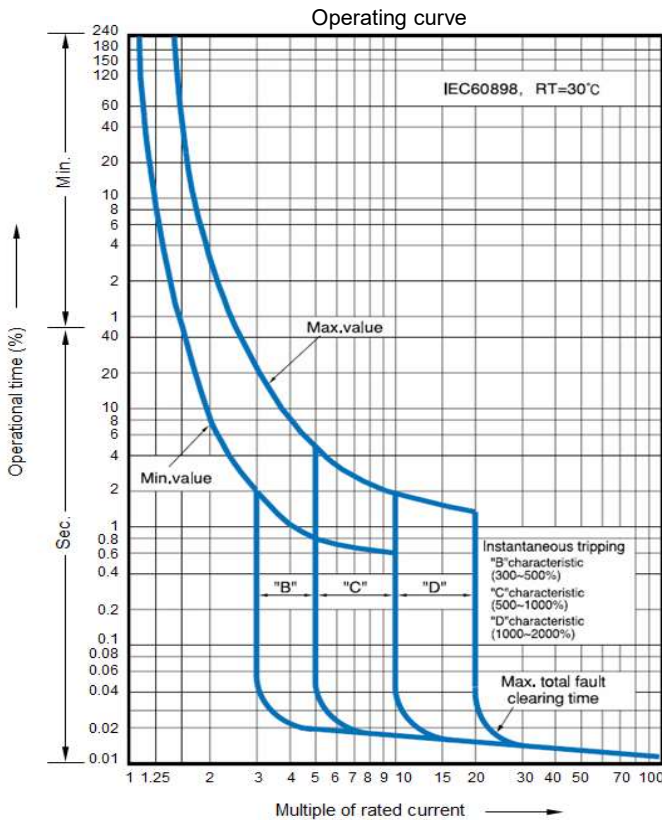

Compensation table

[Temperature compensation table](IEC60898-1)

In(A)	20°C	25°C	30°C	35°C	40°C	45°C	50°C	55°C	60°C
1	1.05	1.02	1.0	0.98	0.95	0.93	0.9	0.89	0.85
2	2.03	2.04	2.0	1.96	1.92	1.88	1.84	1.8	1.74
3	3.18	3.09	3.0	2.91	2.82	2.7	2.61	2.49	2.37
4	4.24	4.12	4.0	3.88	3.75	3.64	3.52	3.36	3.24
6	5.24	6.12	6.0	5.88	5.76	5.64	5.52	5.4	5.3
10	10.6	10.3	10.0	9.7	9.3	9.0	8.6	8.2	7.8
16	16.8	16.5	16.0	15.5	15.2	14.7	14.2	13.8	13.3
20	21.0	20.3	20.0	19.4	19.0	18.4	17.8	17.4	16.8
25	26.2	25.7	25.0	24.2	23.7	23.0	22.2	21.5	20.7
32	33.5	32.9	32.0	31.4	30.4	29.8	28.4	28.2	27.5
40	42.0	41.2	40.0	38.8	38.0	36.8	35.6	34.4	33.2
50	52.5	51.5	50.0	48.5	47.4	45.5	44.0	42.5	40.5
63	66.2	64.9	63.0	61.0	58.0	56.7	54.2	51.7	49.2

[1:113%In 12:145%In according to IEC60898-1]

Compensation curve

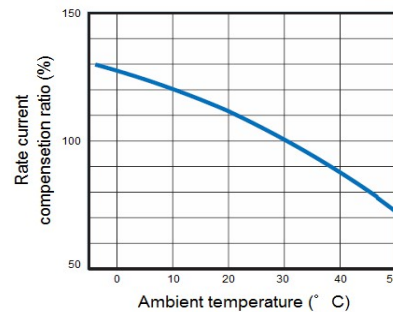

KEY WORD					MS-WORD	
DWG.	O.SITTICHAJ	6-Jul-21	REGD 2021-07 06	DWG No.	SH.	REV.
CHKD.	C.CHONTICHA M.SOMKIAT	6-Jul-21		4HTN001300	1 1	00
APPRD.	S.SUGAI	6-Jul-21				